



# South Coast ORCHID Society, Inc.

LONG BEACH, CALIFORNIA

Meets on the 4th Monday of each Month at Silverado Park Club House, 31st Street and Santa Fe Ave.

*Orchids are gracious living - wear them.*

PAUL BRECHT  
PRESIDENT

FRED H. VAUGHN  
1ST VICE PRESIDENT

DR. ROBERT C. DODSON  
2ND VICE PRESIDENT

WOODROW C. WILSON  
TREASURER

MRS. PATRICIA A. McDONALD  
SECRETARY

MRS. HELEN CZEIKOWITZ  
MEMBERSHIP SECRETARY

LEE N. BENTZEN  
BULLETIN EDITOR

PATRICIA McDONALD  
JANE BRECHT  
ASSISTANT EDITORS

## PROGRAM

### CYMBIDIUM CULTURE FOR SOUTHERN CALIFORNIA

April 27, 1964 - 8:00 p.m.

Mr. Ernest Hetherington from The Fred A. Stewart Co. will give us some timely information on Cymbidium culture and will show us colored slides of new 1964 crosses. This is a program none of us will want to miss.

Mr. William E. Farrell, past-president of The Orchid Digest Corporation was our guest in March. He showed us beautiful colored movies of his recent world tour.

### PLANT PROCUREMENT

The Fred A. Stewart Co. will supply plants of mixed genera for our April meeting--some will be in bloom.

Armacost & Royston provided cattleya plants and seedlings for our March meeting. A Watering Want was provided by Southern California Greenhouse Manufacturers and a bottle of Orchidzyme by Rheinfrank & Hudson.

### PLANT FORUM

Our Plant Forum chairman, Paul Shaub, appointed Lloyd DeGarmo to discuss Species, Murray Spencer - Cattleyas, and Woody Wilson - Cymbidiums. The Fred A. Stewart Co. had a beautiful display of fine Cymbidiums.

### "OPEN GREENHOUSES"

Visitations chairman, V. L. Scoggins, announces that two of our members will hold open house May 10 from 2:00 - 4:30 p.m. We hope that you will be able to drop by and see the collections of Mac Thompson, 5425 Myrtle Ave., Long Beach and Lloyd DeGarmo, 8555 Rose Ave., Bellflower.



### LIBRARY

Our librarians, Mr. and Mrs. Leo Bance, will again accept your orchid magazines for binding at this month's meeting. Remember to tie your magazines in one or two-year bundles and attach your name and address. The charge for a one-year volume is \$3.50 and a two-year volume is \$5.75, payable in advance. There will be a six to eight week delivery period.

### NOVICE CLASS

45 members and guests were present at the Novice Class this month at the home of Col. and Mrs. Morley in Downey. Woodrow Wilson conducted the class in the absence of Dr. Dodson, and a very informative Question and Answer session was conducted.

The next Novice Class will be held on May 3, 1964 at 10:00 a.m. at the home of Mr. and Mrs. Robert Green, 12452 Pine Street, Garden Grove.

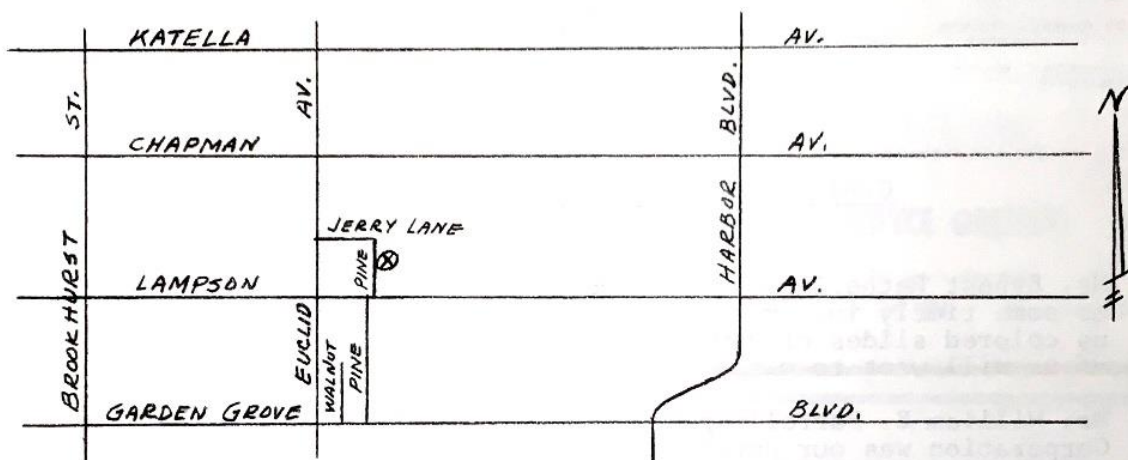

### SOUTH COAST & ORCHID DIGEST REGIONAL JUDGING AWARDS

March 23, 1964

#418 Phal. Estrellita var. "Margaret"  
Owner: John N. Vidulich

HCC 78.2

#### Judges present:

Paul Brecht  
William Farrell  
Nell Howard  
Rolan Howard  
John Hanes  
Elva Hanes  
Leo Holguin  
Dean Field

E. K. Field  
Roy Field  
Emerson Charles  
Woodrow Wilson  
Art Falk  
R. G. Philpott  
Dr. J. Lloyd Wallar,  
Chairman

### MISCELLANEOUS

Mr. Fred Vaughan wishes to thank the orchid society for the beautiful Cymbidium plant and his friends for the many cards he received during his recent illness. We're glad to hear that he is feeling better.

### PHALAENOPSIS — Species

PHAL. LUEDDEMANNIANA .....	\$7.50
pale yellow-green flowers with rust markings. From Philippines	
PHAL. LUEDDEMANNIANA BOXALLII .....	\$5.00 - 7.50
(Fasciata sub variety), Pale yellow green with deep yellow markings	
PHAL. LUEDDEMANNIANA PULCHRA .....	\$3.50 - 5.00 - 7.50
syn. Purpurata. Deep lavender purple — variable — Philippines	
PHAL. EQUESTRIS .....	\$3.50 - 5.00
syn. Rosea. Clusters of rose and white blooms — variable	
PHAL. BUYSSONIANA .....	\$5.00 - 7.50 - 10.00
(Doritis pulcherrima). Pinkish flower — tall erect stems — Summer	
PHAL. SCHILLERIANA .....	\$7.50
mottled leaves, purple beneath, long scapes of rose-purple blooms — Winter	
PHAL. MANNII .....	\$7.50
yellow blooms with brown bar markings	

A complete list of novelty and exhibition type Phalaenopsis upon request.

"VISITORS ALWAYS WELCOME"

### PAUL BRECHT ORCHID CO.

1989 Harbor Boulevard Costa Mesa, California 92627

Phone 548-2314

Hours: 8:30 - 5:00 daily • 11:00 - 5:00 Sunday

2

## LET'S GO TO STEWARTS TODAY!

This is the way many Southland families start a Saturday or Sunday — or any day for that matter. At Stewarts you may browse to your heart's content. Bring the children; they are welcome.

Our salesmen-growers will greet you with a friendly, "May I help you?" but will return to their duties if you are "just looking." You never feel you have to buy at Stewarts. So — come on over and check our bargains!

*Fred A. Stewart, Inc.*

8606 E. Las Tunas Drive

ORCHIDS

San Gabriel, California

ATlantic 7-8974

CUmberland 3-4590

ONE OF THE WORLD'S GREAT ORCHID NURSERIES

3



**ADVERTISING**  
SOUTH COAST ORCHID SOCIETY, INC.

### COMMUNITY POTS

We have had so many requests for Community Pots that we decided to offer a few interesting crosses.

- A-1263 Slc. Helen Veliz #2 x Blc. Nacost 'Dark'. Should be attractive shades of red to bronze.
- AM-51 Lc. Molly Tyler, FCC Self, x Self. This is a second generation self.
- AM-55 Lc. South Esk 'Judy Doig' FCC x Lc. Mem. Walter L. Armacost 'Koi-I-Nur'. Medium to dark lavenders are expected.
- AM-70 Blc. Heron's Ghyll 'Colossus' x Blc. Heron's Ghyll 'Bill Farrell'. Two top Blc. Heron's Ghyll should result in something extra specia.

3 inch pots. 10 plants \$12.50 per pot  
4 inch pots. 15 plants \$15.00 per pot

**Quantities Limited**

### ARMACOST & ROYSTON, INC.

*"Famous For Fine Orchids"*

11910 La Grange Ave. West Los Angeles, Calif. 90025  
Near South Bundy Drive and Olympic Blvd.

### ARE YOU EASILY SATISFIED WITH THE FINEST IN ORCHIDS?

Frankly we are . . . and getting more selective day by day! With this in mind, Madge and I are gathering seedlings we know have only the best chance of satisfying our jaded tastes.

Would you care to join us in "growing on" our selected seedlings?

**Vigorous seedlings in 2" pots .....\$1.50 each**

- # 2—Lc. Elinor (L. Coronet x C. Schroderae, 'The Baron')
- # 3—(Lc. S. J. Bracey x Blc. Nannette) x Lc. Crowborough, 'Sunshine'
- # 6—C. Bob Betts x Blc. Nacouchee, 'Silver Medal'
- #21—Lc. Hertha x C. Labiata, 'Royal'
- #22—C. Dick Whittington (C. Bow Bells x C. Labiata, 'Hereford Hall')
- #24—Lc. Bonanza x C. Labiata, 'Westonbirt'
- #41—C. Vesper x C. Bob Betts, 'Leo Holquin' FCC/AOS

\*We still have excellent plants of the successful remake of Lc. Mem. Albert Heinecke in 3" pots at \$5.00

(Calif. residents please add 4% sales tax)

### FRANK FORDYCE ORCHIDS

*On top of Fire Mt. above Oceanside*

2500 Fire Mt. Dr. Ph. 729-1284 Carlsbad, Calif.

#### S.C.O.S. BULLETIN ADVERTISING RATES

	1 Issue	6 Issues	12 Issues
FULL PAGE	24.00	21.00	18.00
HALF PAGE	12.00	11.00	10.00
1/4 PAGE	7.00	6.00	5.00
1/8 PAGE	4.00	3.50	3.00
1/16 PAGE	2.00	1.75	1.50
1/32 PAGE	1.00	1.00	1.00

Deadline for each months issue — the 5th of each month.

**LEE N. BENTZEN**

4607 Blackthorne Ave. Long Beach 8, Calif. HA 5-1576

## *At Last!* THE BREAKTHROUGH YOU HAVE BEEN WAITING FOR! **Agricultural Enzymes**

### A Vital Supplement To Increase Plant Growth



**Just spray it on and watch the  
results you have always wanted**

*"WHAT ARE ENZYMES?"*

Enzymes are nature's chemical tools. They act as organic catalysts that speed up chemical changes in cells without taking part in the change themselves.

These enzymes, amylase and protease, break down the complex food materials into simpler, more assimilable forms. As a result, this encourages growth of roots, foliage, and stimulates early blooms. Leaves assume a more erect stance and plants become more tolerant to light.

Orchid-zymes are compatible with other insecticides, fungicides, and fertilizers and may be applied in conjunction with these, even in a "shot gun" application. "Orchid-zymes" is **not** just another plant food, but truly a **new and proven** product that contributes to the growth of plants.

It is completely available to plants giving **quick and lasting** results.

**An Important Bonus:** "Orchid-zymes" will greatly reduce algae on pots, benches, compost and floors. It dissolves the unsightly white encrustations of fertilizers and chemicals that normally burn sensitive root tips.

Pints \$2.79

Quarts \$4.19

Gallons \$8.95

25% grower discount on case of four gallons  
F.O.B. our Los Angeles warehouse  
DEALER PRICE LIST ON REQUEST

**Rheinfrank & Hudson**

5414 SIERRA VISTA AVE. • LOS ANGELES 38, CALIF.  
HO 5-2578 or HO 5-4146